

JUNIOR

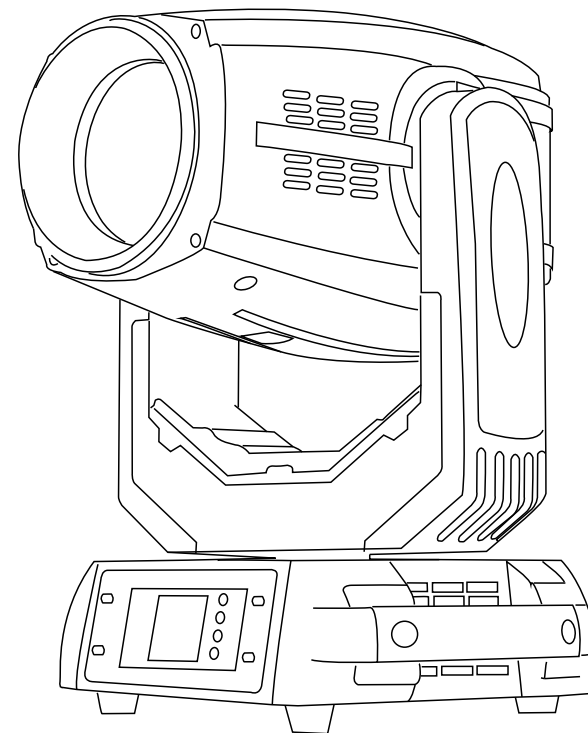

JNR BWS 350 JNR-8152A

PR LIGHTING LTD.
<http://www.pr-lighting.com>
1582 Xingye Avenue, Nancun Panyu
Guangzhou, 511442 China
TEL: +86-20-3995 2888

1 SAFETY INSTRUCTIONS



CAUTION

Becareful with your operations. With a dangerous voltage you can suffer a dangerous electric shock when touching wires!

This device has left the factory in perfect condition. In order to maintain this condition and to ensure a safe operation, it is absolutely necessary for the user to follow the safety instructions and warning notes written in this user manual.



IMPORTANT

Damages caused by the disregard of this user manual are not subject to warranty. The dealer will not accept liability for any resulting defects or problems.

If the device has been exposed to temperature changes due to environmental changes, do not switch it on immediately. The arising condensation could damage the device. Leave the device switched off until it has reached room temperature.

This device falls under protection-class I. Therefore it is essential that the device be earthed.

The electric connection must carry out by qualified person.

The device shall only be used with rated voltage and frequency.

Make sure that the available voltage is not higher than stated at the end of this manual.

Make sure the power cord is never crimped or damaged by sharp edges. If this would be the case, replacement of the cable must be done by an authorized dealer.

Always disconnect from the mains, when the device is not in use or before cleaning it. Only handle the power cord by the plug. Never pull out the plug by tugging the power cord.

During initial start-up some smoke or smell may arise. This is a normal process and does not necessarily mean that the device is defective, it should decrease gradually.

Please don't project the beam onto combustible substances.

Fixtures cannot be installed on combustible substances, keep more than 50cm distance with wall for smooth air flow, so there should be no shelter for fans and ventilation for heat radiation.

If the external flexible cable or cord of this luminaire is damaged, it shall be exclusively replaced by the manufacturer or his service agent or a similar qualified person in order to avoid a hazard.

20		Focus fine	0-255	Focus fine
21		Auto focus	0	No function
			1-128	Auto focus
			129-250	No function
			251-255	Open static gobo, rotation gobo auto focus function
22	15	Strobe	0-31	Strobe off
			32-63	Shutter open, full lamp power
			64-95	Strobe-effect from slow to fast
			96-127	Shutter open
			128-143	Opening pulse in sequences from slow to fast
			144-159	Closing pulse in sequences from fast to slow
			160-191	Shutter open
			192-223	Random strobe-effect from slow to fast
			224-255	Shutter open, full lamp power
23	16	Dimmer	0-255	Linear dimmer
24				Blank

			168-175	Gobo 9 shake from slow to fast
			176-183	Gobo 10 shake from slow to fast
			184-191	Gobo 11 shake from slow to fast
			192-199	Gobo 12 shake from slow to fast
			200-225	Forwards gobo rotation from fast to slow
			226-229	Gobo rotation stop
			230-255	Backwards gobo rotation from slow to fast
12	9	Gobo rotation	0-127	Gobo indexing
			128-190	Counterclockwise rotation from fast to slow
			191-192	Stop
			193-255	Clockwise rotation from fast to slow
13		Fine	0-255	Fine
14	10	Prism	0-19	Blank
			20-49	16-facet linear rotating prism -indexing
			50-75	16-facet linear rotating prism-rotation
			76-105	Blank
			106-127	Blank
			128-135	Macro 1
			136-143	Macro 2
			144-151	Macro 3
			152-159	Macro 4
			160-167	Macro 5
			168-175	Macro 6
			176-183	Macro 7
			184-191	Macro 8
			192-199	Macro 9
			200-207	Macro 10
			208-215	Macro 11
			216-223	Macro 12
			224-231	Macro 13
			232-239	Macro 14
			240-247	Macro 15
			248-255	Macro 16
15	11	Prism rotation	0-127	Prism rotation and indexing
			128-191	Counterclockwise rotation from fast to slow
			192-193	Blank
			194-255	Clockwise rotation from fast to slow
16	12	Frost	0-64	Blank
			65-255	Linear frost
17	13	Zoom	0-255	Linear zoom
18		Zoom fine	0-255	Zoom fine
19	14	Focus	0-255	Focus

2 UNPACKING

Thank you for choosing our JNR BWS 350. For your own safety, please read this manual before installing the device. This manual covers the important information on installation and applications. Please install and operate the fixture with following instructions. Meanwhile, please keep this manual well for future needs.

The JNR BWS 350 is made of a new type of high temperature strength of engineering plastics and cast aluminum casing with nice outlook. The fixture is designed and manufactured strictly following CE standards, complying with international standard DMX512 protocol. It's available independently controlled and linkable with each other for operation. And it is applicable for large-scale live performances, theater, studio, nightclubs and discos.

The JNR BWS 350 adopts 1*350W YODN lamp which features high brightness and stability. Please carefully unpack it when you receive the fixture and check whether it is damaged during the transportation. And please check whether the following items are included inside the box:

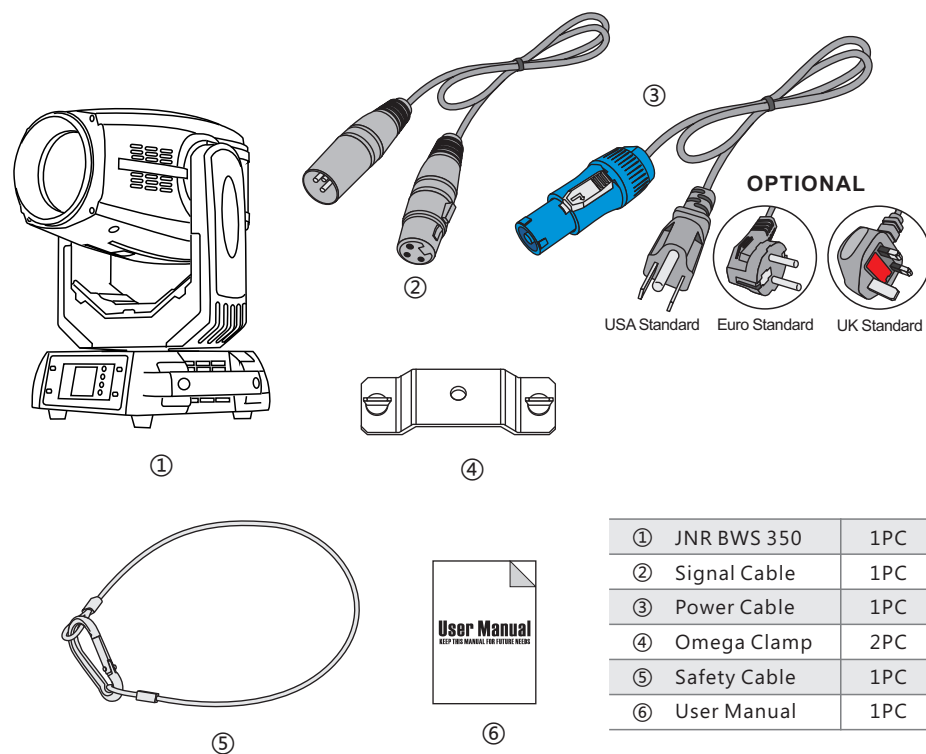

①	JNR BWS 350	1PC
②	Signal Cable	1PC
③	Power Cable	1PC
④	Omega Clamp	2PC
⑤	Safety Cable	1PC
⑥	User Manual	1PC

3 FEATURES & SPECIFICATIONS

Features

- A YODN 350W lamp included
- A Philip 350W lamp is optional
- Electronic ballast
- 2200 Hours lamp life span
- No need for adjustment of reflector or lamp
- High resolution anti-reflection glass lenses
- 540°PAN and 270° TILT movement
- Automatic Pan / Tilt position correction
- 16-bit smooth and precise resolution for PAN/TILT movement
- Fast, quiet and accurate Pan / Tilt positioning
- Rotating gobo wheel with 12 rotatable, indexable and interchangeable gobos plus open
- Variable speed gobo scrolling in both directions
- 12mm external diameter, 5.5mm image diameter (Gobo Size)
- Static gobo wheel with 17 gobos plus open
- Color wheel with total 13 colors plus open
- Two color modes (Full color mode and half-color mode)
- Variable direction rainbow effect with speed adjustable
- 16-Facet circular prism with speed adjustable and variable direction
- Prisms combined available
- Variable Frost Filter (Hybrid effect for wash with 22°-37° zoom range)
- Macro-function for gobos/prism combinations
- Dual flag mechanical dimming system
- Variable speed strobe effect
- Preset variable/random strobe and dimming pulse effects
- Motor driven focus from near to far
- Linear motorized ZOOM (3°-29°)
- ZOOM range: 3°-10° beam application; 5°-29° spot application
- 2 DMX channel modes, 16CH and 24CH (USITT DMX-512)
- DMX, stand-alone, master/slave, sound activated mode
- DMX recorder and edit function integrated
- 2.4" TFT LCD touch screen display with 4 control buttons
- POWRECON connector IN
- 3-Pin&5-Pin XLR connectors IN/OUT
- Fan cooling system
- Constant temperature readout / management function
- DB rating @ 1M = 54,18db
- 2 *1/4 turn fastening Omega clamps
- 1* Safety attachment point

11	8		97-102	Gobo 16
			103-108	Gobo 17
			109-114	Gobo 1 shake from slow to fast
			115-120	Gobo 2 shake from slow to fast
			121-126	Gobo 3 shake from slow to fast
			127-132	Gobo 4 shake from slow to fast
			133-138	Gobo 5 shake from slow to fast
			139-144	Gobo 6 shake from slow to fast
			145-150	Gobo 7 shake from slow to fast
			151-156	Gobo 8 shake from slow to fast
			157-162	Gobo 9 shake from slow to fast
			163-168	Gobo 10 shake from slow to fast
			169-174	Gobo 11 shake from slow to fast
			175-180	Gobo 12 shake from slow to fast
			181-186	Gobo 13 shake from slow to fast
			187-192	Gobo 14 shake from slow to fast
			193-198	Gobo 15 shake from slow to fast
			199-204	Gobo 16 shake from slow to fast
			205-210	Gobo 17 shake from slow to fast
			211-231	Forwards gobo rotation from fast to slow
			232-234	Gobo rotation stop
			235-255	Backwards gobo rotation from slow to fast
		Rotation gobo wheel	0-7	Blank
			8-15	Gobo 1
			16-23	Gobo 2
			24-31	Gobo 3
			32-39	Gobo 4
			40-47	Gobo 5
			48-55	Gobo 6
			56-63	Gobo 7
			64-71	Gobo 8
			72-79	Gobo 9
			80-87	Gobo 10
			88-95	Gobo 11
			96-103	Gobo 12
			104-111	Gobo 1 shake from slow to fast
			112-119	Gobo 2 shake from slow to fast
			120-127	Gobo 3 shake from slow to fast
			128-135	Gobo 4 shake from slow to fast
			136-143	Gobo 5 shake from slow to fast
			144-151	Gobo 6 shake from slow to fast
			152-159	Gobo 7 shake from slow to fast
			160-167	Gobo 8 shake from slow to fast

			45-53	Magenta
			54-60	Yellow
			63-71	Blue
			72-80	Bark green
			81-89	Rose red
			90-98	Amber
			99-107	Lower the temperature
			108-116	Blue fluorescence
			117-127	Purple
			128-129	White
			130-134	Deep red
			135-138	Dark yellow
			139-143	Deep blue
			144-147	Green
			148-152	Magenta
			153-157	Yellow
			158-161	Blue
			162-166	Dark green
			167-171	Rose
			172-176	Amber
			177-180	Lower the temperature
			181-185	Blue fluorescence
			186-189	Purple
			190-222	from fast to slow
			223-255	from slow to fast
8		Color	0-255	Color fine
9	6	Gobo	0-255	Rotation gobo speed
10	7	Static gobo Wheel	0-6	Blank
			7-12	Gobo 1
			13-18	Gobo 2
			19-24	Gobo 3
			25-30	Gobo 4
			31-36	Gobo 5
			37-42	Gobo 6
			43-48	Gobo 7
			49-54	Gobo 8
			55-60	Gobo 9
			61-66	Gobo 10
			67-72	Gobo 11
			73-78	Gobo 12
			79-84	Gobo 13
			85-90	Gobo 14
			91-96	Gobo 15

Specifications

Input Voltage: AC100-240V 50/60Hz
Lamp Quantities: 1*350W YODN lamp
Control Signal: DMX512, master-slave and sound activated or auto operation
Control Channel: 24/16DMX channels USITT DMX-512
Power Consumption: 500W
Dimensions: 380(D)*260(W)*600(H)mm
Packing Dimensions: 465(D)*450(W)*680(H)mm
Net Weight: 19kg
Gross Weight: 22.6kg

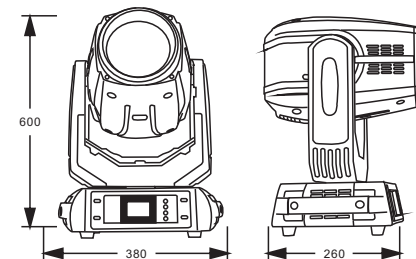

4 PHOTOMETRIC DATA

Photometric Beam Angle Data 3°-29° Beam Angle

29°Lux	20490	5122	2277	1281	820	569
3°Lux	812855	203214	90317	50803	32514	22579

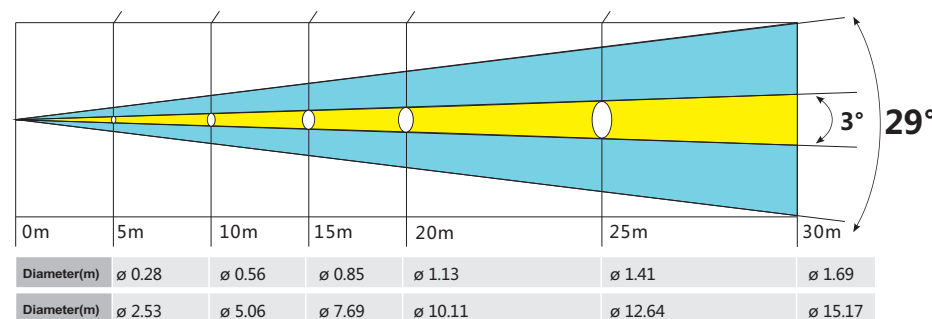

5 OPERATION INSTRUCTIONS

- The JNR BWS 350 is for beam effect for on-site decoration purpose.
- Don't turn on the fixture if it's been through severe temperature difference like after transportation because it might damage the light due to the environment changes. So make sure to operate the fixture until it is in normal temperature.
- This light should be keep away from strong shaking during any transportation or movement.

- Don't pull up the light by only the head, or it might cause damages to the mechanical parts.
- Don't expose the fixture in overheat, moisture or environment with too much dust when installing it. And don't lay any power cables on the floor. Or it might cause electronic shock to the people.
- Make sure the installation place is in good safety condition before installing the fixture.
- Make sure to put the safety chain and check whether the screws are screwed properly when installing the fixture.
- Make sure the lens are in good condition. It's recommended to replace the units if there are any damages or severe scratch.
- Make sure the fixture is operated by qualified personnel who knows the fixture before using.
- Keep the original packages if any second shipment is needed.
- Don't try to change the fixtures without any instruction by the manufacturer or the appointed repairing agencies.
- It is not in warranty range if there are any malfunctions from not following the user manual to operate or any illegal operation, like shock short circuit, electronic shock, lamp broke, etc.

6 INSTALLATIONS

Cautions: For added protection mount the fixtures in areas outside walking paths, seating areas, or in areas where the fixture might be reached by unauthorized personnel.



Before mounting the fixture to any surface, make sure that the installation area can hold a minimum point load of 10 times the device's weight.

Fixture installation must always be secured with a secondary safety attachment, such as an appropriate safety cable.

Never stand directly below the device when mounting, removing, or servicing the fixture.





from a ceiling, or set on a flat level surface (see illustration below). Be sure this fixture is kept at least 0.5m (1.5 ft) away from any flammable materials (decoration etc.).

Always use and install the supplied safety cable as a safety measure to prevent accidental damage and/or injury in the event the clamp fails.

Lamp Setting				Choose lamp on/off by console
				Return to manual
				Display 180° reverse
				Language
				Esc

9 DMX CHANNELS

Mode/Channel		Function	Values	Description
Standard	Basic			
1	1	PAN	0-255	PAN
2		PAN-fine	0-255	PAN Fine
3	2	TILT	0-255	TILT
4		TILT-fine	0-255	TILT Fine
5	3	TILT/PAN	0-255	TILT/PAN speed
6	4	Macro	0-19	Blank
			20-24	Eco mode(Lamp power 230W)
			25-29	Standard mode(Lamp power 280W)
			30-49	Blank
			50-59	PAN/TILT speed mode
			60-69	PAN/TILT time mode
			70-79	Blackout while PAN/TILT moving
			80-89	Disabled blackout while PAN/TILT moving
			90-99	Blackout while color wheel moving
			100-109	Disabled blackout while color wheel moving
			110-119	Blackout while gobo wheel moving
			120-129	Disabled blackout while gobo wheel moving
			130-139	Lamp On,reset(total reset except PAN/TILT)
			140-149	PAN/TILT reset
			150-189	Color system reset
			190-199	Blank
			200-209	Total reset
			210-229	Blank
			230-239	Lamp off
			240-255	Blank
7	5	Color Wheel	0-8	Open/White
			9-17	Deep red
			18-26	Dark yellow
			27-35	Deep blue
			36-44	Green

 Manual Setting	Reset			Factory reset
	Save			Save the setting
	Back			Back Home manual display
	Fixture Reset	All Motor	Yes	All Motor self check
			No	Back last step
		Some Motor	Yes	Small motor self check
			No	Back Last step
		XY Motor	Yes	Scan motor self check
			No	Back last step
	Test	Auto	Enter	Run Macro program
			Back	Back last step
Sound		Enter	Macro run by sound	
		Back	Back last step	
Analog console		CH1-CH32	Manual control relevant Channels function	
Back			Back home manual display	
 Inquire	Channel level		CH1-CH32	Show DMX value
	Other Info			Show fixture work and software info
	Error Info			Display fixture error info
	Back			Back home manual display
 Display Setting	Brightness		1-7 Volume	Highter mean display more bright
	Back light delay		always	Display always on
			30 Seconds	Display no operation 30 seconds display being dark
			20 Seconds	Display no operation 20 seconds display being dark
			10 Seconds	Display no operation 10 seconds display being dark
	Manual back		No Return	Display no operation Manual no return
	Manual back		10 Seconds	Display no operation 10 seconds Back home Manual
			20 Seconds	Display no operation 20 seconds Back home Manual
			30 Seconds	Display no operation 30 seconds back home manual
	Back light Flashing		Off	No signal display normal
			On	No signal display will flash
	Back			Back last step
	Save			Save the setting
Back			Back home manual	
	Default			Light up if power on
	Manual control			Manual control the lamp on/off

Mounting points: Overhead mounting requires extensive experience, including amongst others calculating working load limits, a fine knowledge of the installation material being used, and periodic safety inspection of all installation material and the fixture. If you lack these qualifications, do not attempt the installation yourself. Improper installation can result in bodily injury.

Be sure to complete all rigging and installation procedures before connecting the main power cord to the appropriate wall outlet.

Clamp mounting: The JNR BWS 350 provides a unique mounting bracket assembly that integrates the bottom of the base, and the safety cable rigging point in one unit (see the illustration below). When mounting this fixture to truss be sure to secure an appropriately rated clamp to the included omega bracket using a M10 screw fitted through the center hole of the "omega bracket". As an added safety measure be sure to attached at least one properly rated safety cable to the fixture using on of the safety cable rigging point integrated in the base assembly.

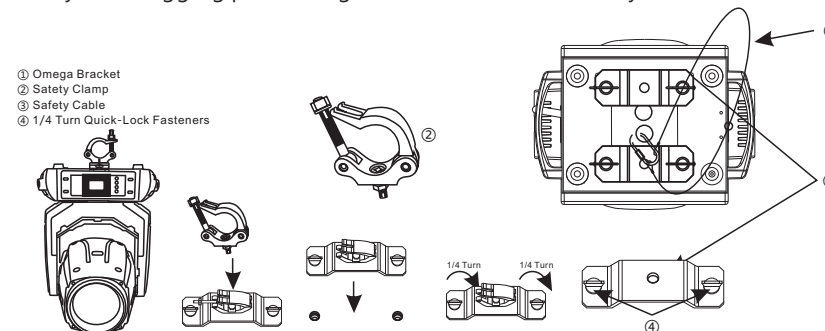

Regardless of the rigging option you choose for your JNR BWS 350, always be sure to secure your fixture with a safety cable. The fixture provides a built-in rigging point for a safety cable on the hanging bracket as illustrated above. Be sure to only use the designated rigging point for the safety cable and never secure a safety cable to a carrying handle.

7 DMX-512 CONTROL CONNECTIONS

Connect the provided XLR cable to the female 3-pin XLR output of your controller and the other side to the male 3-pin XLR input of the moving head. You can chain multiple

Moving head together through serial linking. The cable needed should be two core, screened cable with XLR input and output connectors. Please refer to the diagram below.

DMX-512 connection with DMX terminator

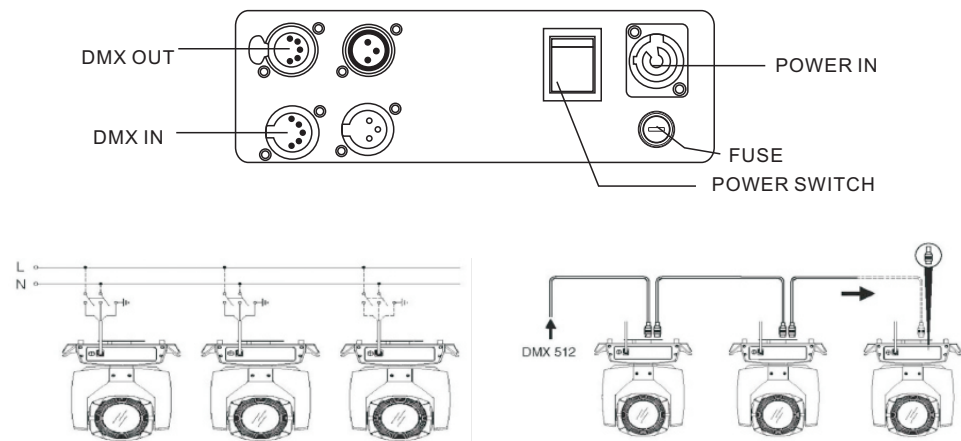

If you connect fixtures to AC power in a linked chain, please do not link more than:

1. Three(3) fixtures at 100-120VAC, 50/60Hz.
2. Four(4) fixtures at 200-240 V, 50/60Hz.

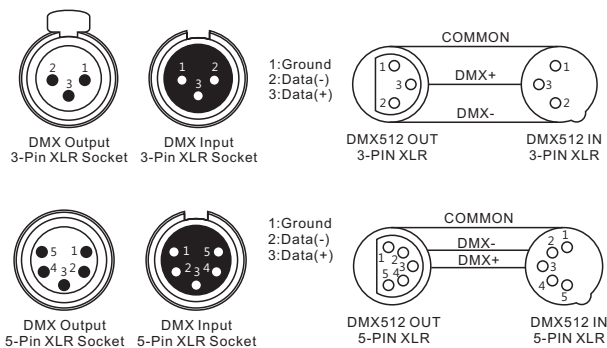

For installations where the DMX cable has to run a long distance or is in an electrically noisy environment, such as in a discotheque, it is recommended to use a DMX terminator. This helps in preventing corruption of the digital control signal by electrical noise. The DMX terminator is simply an XLR plug with a 120 Ω resistor connected between pins 2 and 3, which is then plugged into the output XLR socket of the last fixture in the chain. Please see illustrations below.

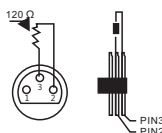

8 MENU OPERATIONS

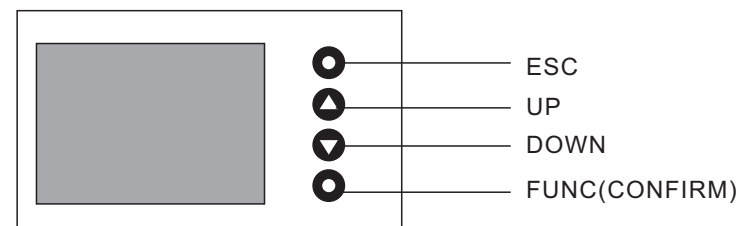

Operation of LCD display

Manual	Sub Manual 1	Sub Manual 2	Function	Details
 Setup	Running mode		DMX mode	Choose Fixture receive signal mode
			Wireless mode	
			Auto mode	
	Channel mode		Standard	Choose fixture running CH
			Simplify	
			Custom	
	PAN reverse		Off	PAN scan forward
			On	PAN scan reverse
	TILT reverse		Off	TILT scan forward
			On	TILT scan reverse
	PAN degree		540	PAN 540°running
			360	PAN 360°running
	Optocoupler detection		On	On scan correction function
			Off	Off scan correction function
	No DMX signal		Cleared	Back to Initial after function
			Save	Stay last value after signal cut
	Color wheel		Haft color	Enable haft color function
			Full color	Disable haft color function
	Shortest Distance		On	Effect wheel back zero from shortes troute
			Off	Effet wheel back zero from running direction
	Back			Back last step Manual
	Advance setting	Null		Please contact the dealer or menu facturer
		Adjustment		
		CH definition		
		Factory set		
		Use Management		
		Back		